



MELFORD COURT, 3-5 CAVENDISH ROAD, SUTTON, SM2 5ET
£225,000 LEASEHOLD



MELFORD COURT, 3-5 CAVENDISH ROAD SUTTON, SM2 5ET

**Desirable One Bedroom First Floor Flat
In a Purpose-Built Development
Situated In a Quiet Location Within Easy Reach of
Sutton Mainline Station
Modern Kitchen and Bathroom
Electric Heating
Private Off-Street Parking • EPC Grade B
Council Tax Band C**

A desirable one-bedroom first-floor flat in a quiet, convenient location near Sutton & Belmont BR Stations and Sutton Town Centre. Presented in excellent condition, it features double-glazed windows, built-in wardrobes, a modern kitchen and shower room, electric heating, and is fully carpeted. Additional benefits include private off-street parking. Early viewing highly recommended.

**Ideal purchase for First-Time Buyers
or as a Rental Investment**



FIRST FLOOR

LOUNGE 16'8" × 9'6" (5.09m × 2.90m)

Bright and spacious lounge with double glazed windows and electric heating.

BEDROOM 11'4" × 8'8" (3.45m × 2.64m)

Double bedroom with double glazed window and electric heating. Wardrobes.

KITCHEN 8'3" × 8'2" (2.52m × 2.50m)

Modern fitted kitchen featuring ample work surfaces, a range of base and wall-mounted units, and an extractor fan.

BATHROOM

Modern bathroom with walk in shower.

- Lease: 89 years unexpired.
- Maintenance/Service charge (including buildings insurance) £2,022.00 pa.
- Ground Rent £150.00 pa.



Melford Court SM2

Approximate Gross Internal Area = 43 sq m / 462 sq ft

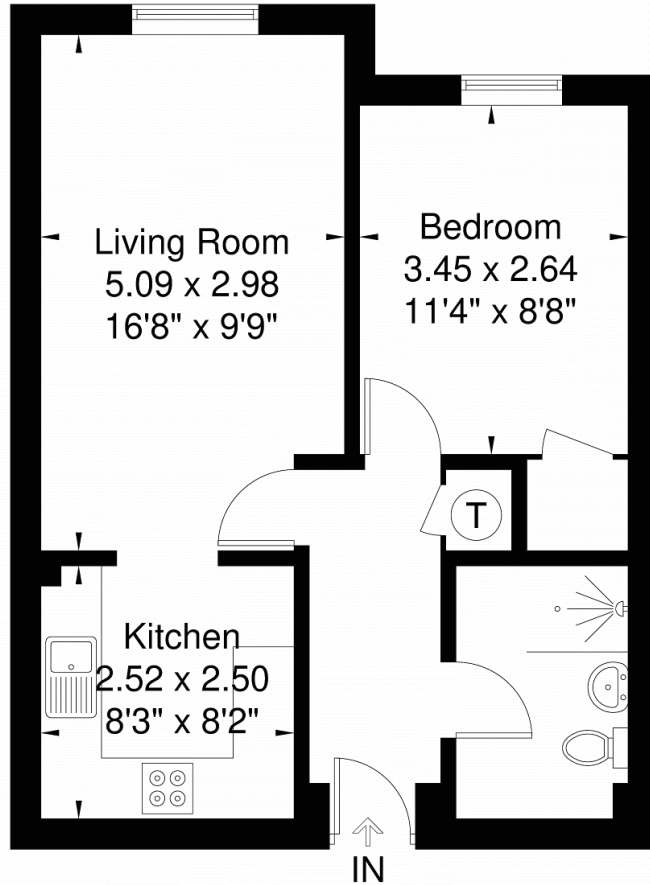

First Floor

43 sq m / 462 sq ft



www.epc.uk.com info@epc.uk.com

Not to scale, for guidance only and must not be relied upon as a statement of fact. All measurements and areas are approximate only and have been prepared in accordance with the current edition of RICS code of Measuring Practice.

HES PARRY & DREWETT (SUTTON) IS A TRADING NAME OF C & C ESTATES SOUTHERN LTD, A LIMITED COMPANY REGISTERED IN ENGLAND & WALES. COMPANY NUMBER 15446105. REGISTERED OFFICE: 4 BETCHWORTH PLACE, DORKING, RH4 1BF. C & C ESTATES SOUTHERN LTD FOR THEMSELVES AND FOR VENDORS OR LESSORS OF THIS PROPERTY WHOSE AGENTS THEY ARE GIVE NOTICE THAT THE PARTICULARS CONTAINED HERE ARE SET OUT AS GENERAL OUTLINE ONLY FOR THE GUIDANCE OF INTENDED PURCHASERS OR LESSEES, AND DO NOT FORM PART OF ANY OFFER OR CONTRACT. ALL DESCRIPTIONS, DIMENSIONS, REFERENCE TO CONDITION AND NECESSARY PERMISSIONS FOR USE AND OCCUPATION, AND OTHER DETAILS ARE GIVEN WITHOUT RESPONSIBILITY AND ANY INTENDING PURCHASERS OR LESSEES SHOULD NOT RELY ON THEM AS STATEMENTS OR REPRESENTATIONS OF FACT BUT MUST SATISFY THEMSELVES BY INSPECTION OR OTHERWISE AS TO THE CORRECTNESS OF EACH OF THEM.

VIEWING STRICTLY BY APPOINTMENT ONLY
THROUGH THE VENDORS AGENTS HES PARRY
& DREWETT (SUTTON)

SUTTON SALES
1 GROVE ROAD, SUTTON, SM1 1BB
020 8642 2266
sutton@hesresidential.co.uk

Energy Performance Certificate		Energy Rating	
Score	Energy Rating	Current	Potential
92+	A		
81-91	B	82	84
69-80	C		
55-68	D		
39-54	E		
21-38	F		
1-20	G		



www.hugginsedwards.co.uk

